

SURVEY FOR DAVID D. BOHANNON ORGANIZATION  
 IN EDEN TOWNSHIP, ALAMEDA COUNTY, CALIFORNIA  
 FOR PROPOSED NEW ASPHALT CONCRETE PAVEMENT IN  
 BOAT DISPLAY AND SALES AREA

Surveyed: October 8, 1969  
 Scale: 1 Inch=10 Feet  
 Datum Elevation: U.S.C. & G.S. Base

*John A. Mancini*  
 JOHN A. MANCINI, R.E. No. 1592  
 1279 "A" Street, Hayward, Calif.

LEGEND  
 Existing Pavement Elevations \_\_\_\_\_

REFER  
 F.B. 473, p. 21  
 Survey No. 5202

NOTE: New Asphalt Concrete Pavement shall be constructed on a Straight Grade from the Limits of the New Asphalt Pavement to the Top of the New Storm Water Inlet.

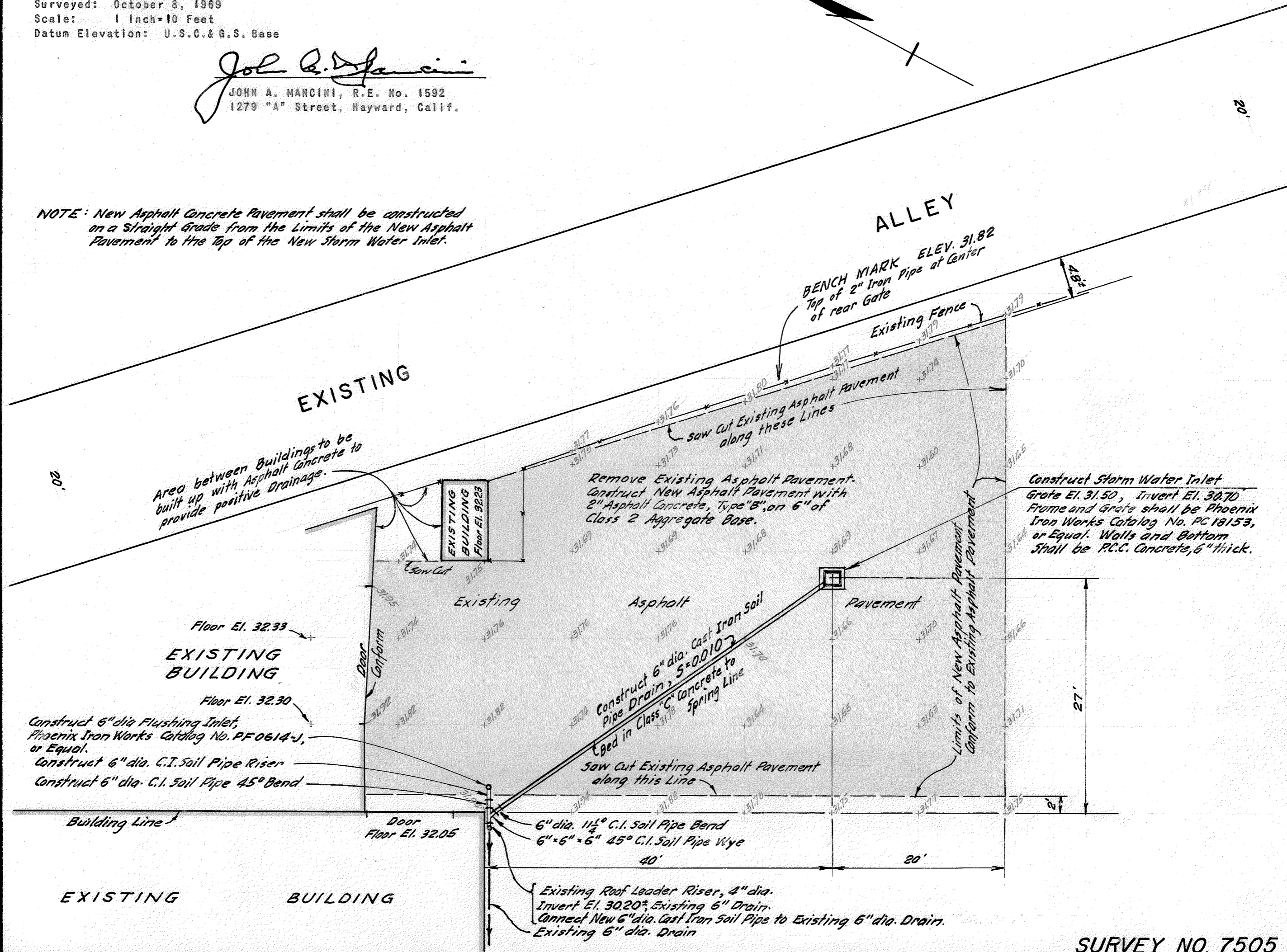

SURVEY NO. 7505